

## Prolunga inox

**Caratteristiche: PROLUNGA INOX 3A - USDA**

**Features: HYGIENIC EXTENSION - USDA EXTENSION**

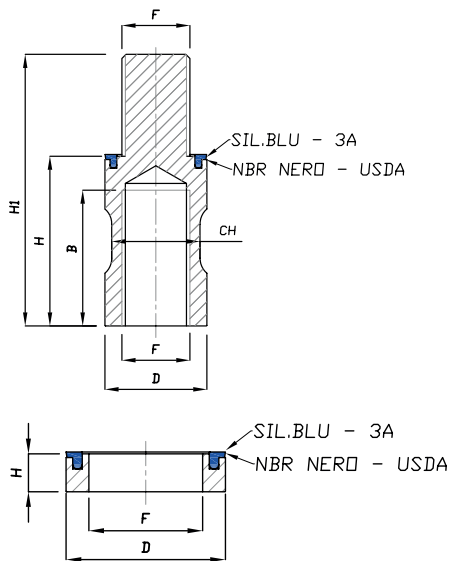

| CODICE - CODE                             |                                  | DIMENSIONI PRINCIPALI - MAIN DIMENSIONS |           |           |           |           |           |
|---|----------------------------------|---|-----------|-----------|-----------|-----------|-----------|
| LUCIDA - POLISHED<br>BLUE SILICONE GASKET | SCOTCH BRITE<br>BLACK NBR GASKET | F                                       | B         | D         | H         | H1        | CH        |
| <b>PROL2450/M12/3A</b>                    | <b>PROL2450/M12/USDA</b>         | <b>M12</b>                              | <b>40</b> | <b>24</b> | <b>50</b> | <b>72</b> | <b>20</b> |
| <b>PROL2450/3A</b>                        | <b>PROL2450/USDA</b>             | <b>M16</b>                              | <b>40</b> | <b>24</b> | <b>50</b> | <b>76</b> | <b>20</b> |
| <b>PROL3050/3A</b>                        | <b>PROL3050/USDA</b>             | <b>M20</b>                              | <b>40</b> | <b>30</b> | <b>50</b> | <b>80</b> | <b>26</b> |
| <b>PROL3550/3A</b>                        | <b>PROL3550/USDA</b>             | <b>M24</b>                              | <b>40</b> | <b>35</b> | <b>50</b> | <b>84</b> | <b>30</b> |
| <b>PROL4250/3A</b>                        | <b>PROL4250/USDA</b>             | <b>M30</b>                              | <b>40</b> | <b>42</b> | <b>50</b> | <b>90</b> | <b>36</b> |

| CODICE - CODE                             |                                  | DIMENSIONI PRINCIPALI - MAIN DIMENSIONS |           |           |
|---|----------------------------------|---|-----------|-----------|
| LUCIDA - POLISHED<br>BLUE SILICONE GASKET | SCOTCH BRITE<br>BLACK NBR GASKET | F                                       | D         | H         |
| <b>PROL2410/F12/3A</b>                    | <b>PROL2410/F12/USDA</b>         | <b>12</b>                               | <b>24</b> | <b>10</b> |
| <b>PROL2410/F16/3A</b>                    | <b>PROL2410/F16/USDA</b>         | <b>16</b>                               | <b>24</b> | <b>10</b> |
| <b>PROL3010/F20/3A</b>                    | <b>PROL3010/F20/USDA</b>         | <b>20</b>                               | <b>30</b> | <b>10</b> |
| <b>PROL3510/F24/3A</b>                    | <b>PROL3510/F24/USDA</b>         | <b>24</b>                               | <b>35</b> | <b>10</b> |
| <b>PROL4210/F30/3A</b>                    | <b>PROL4210/F30/USDA</b>         | <b>30</b>                               | <b>42</b> | <b>10</b> |

• Prolunga **IGIENICA** per piedi certificati **3A**, ideale per l'industria lattiero casearia, farmaceutica e alimentare.  
Materiale: acciaio inox AISI 304, guarnizione silicone blu.

• Prolunga igienica per piedi certificati **USDA**, ideale per l'industria lattiero casearia, farmaceutica e alimentare.  
Materiale: acciaio inox AISI 304, guarnizione nbr nero.

• **HYGIENIC** extension for **3A** feet, ideal for dairy, pharmaceutical and food industry. Material: stainless steel AISI 304, blue silicone gasket.

• Extension for **USDA** feet, ideal for dairy, pharmaceutical and food industry. Material: stainless steel AISI 304, black nbr gasket.

