

DECLARATION OF CONFORMITY

Hygienic Components

MOUNTED BEARING UNITS

Housing Type: SP, SPA, STL, SFL, SBL, SF

Inserts: MB, MUC, MBG

MOVET® Components, HADI GmbH Industrievertretungen, hereby declare that the listed materials applied for the products comply with the demands for materials used within the hygienic industries like food and pharma. All information is based on current state of knowledge and is subject to change.

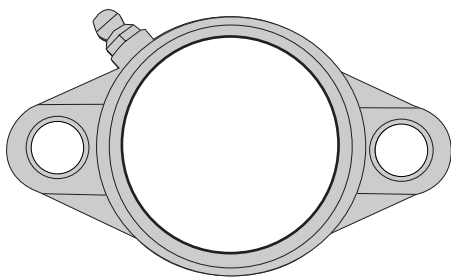

Stainless Steel Housing

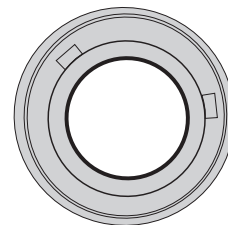
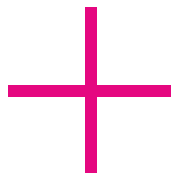

Stainless Steel Insert

DECLARATION OF CONFORMITY

All MOVET series bearings are supplied with Mobile FM FDA Grease which has the following properties:

Application:

Material type housing:

Colors:

Material type grease nipple & mounting holes:

Flange Bearing Housing

Stainless Steel

silver white

Stainless Steel, 1.4301, AISI 304 (X5CrNi18-10)

Features

Non-Toxic Formulation

Very Good Anti-wear Properties

Excellent Oxidation Stability

High Level Corrosion Protection

Meets a Wide Range of equipment requirements

Excellent Air Separation Characteristics

Very Good Water Separation Properties

Advantages and Potential Benefits

Allows use in food packaging and processing applications

Reduces wear and extends equipment life

Provides long oil and equipment life and extends filter life

Prevents internal hydraulic system corrosion

Reduces negative effects of moisture in systems

Provides corrosion protection of multi-metallurgy component designs

Reduced potential for product misapplication

Reduces foaming and it's negative effects

Protects systems where small quantities of moisture are present

Readily separates larger quantities of water